



SECTION 14

MEDIUM VOLTAGE TRANSFORMERS

5KV Class Dry Type Single Phase and Three Phase

Aluminum & Copper, NEMA 1 Features	234
Single Phase Aluminum Selection Tables	235
Single Phase Copper Selection Tables	236
Three Phase Aluminum Selection Tables	237
Three Phase Copper Selection Tables	239
Termination Details	270
Accessories - Sprinkler Hoods & Anti-Vibration Pads	273

5KV CLASS DISTRIBUTION TRANSFORMERS

Hammond medium voltage transformers are designed for stepping down incoming higher voltage power to utilize voltages for commercial, institutional or industrial applications. The standard ventilated construction is suitable for indoor applications.

ALUMINUM & COPPER WOUND FEATURES

SINGLE PHASE

15 to 333 kVA



THREE PHASE

15 to 750 kVA



SINGLE PHASE

THREE PHASE

FEATURE	15 to 333 kVA	15 to 750 kVA
UL Listed	Available Upon Request	Available Upon Request
CSA Certified	File: LR3902	File: LR3902
Frequency	60 Hz	60 Hz
Insulation System	220°C (150°C rise)	185°C (115°C rise) > up to 150kVA Aluminum or 225kVA Copper. 220°C (150°C rise) > 225kVA and up Aluminum or 300kVA and up Copper.
Enclosure Type	Heavy Duty Ventiladed NEMA Type 1	Heavy Duty Ventiladed NEMA Type 1
Enclosure Finish	ANSI 61 Grey	ANSI 61 Grey
Standard Primary Taps	Refer to wiring diagrams for details.	Refer to wiring diagrams for details.
Termination	Front accessible separate high and low voltage terminals; connectors (up to 340A) suitable for copper and aluminum are provided for easy cable installation.	Front accessible separate high and low voltage terminals; connectors (up to 340A) suitable for copper and aluminum are provided for easy cable installation.
Conduit Knock-Outs	On all 15 to 100kVA units.	On all 15 to 150kVA units.
Impedance	Typically 2 to 5%.	Typically 4 to 6%.
Mounting	Standard Floor Mounting. Optional wall mounting kits are available for units from 15 to 50 kVA.	Standard Floor Mounting. Optional wall mounting kits are available for units from 15 to 75 kVA.

Other voltages not listed in this section are available upon request for both aluminum and copper wound units. Please contact customer service for details, price and availability.



ALUMINUM WOUND, SINGLE PHASE, NEMA 1 STYLE ENCLOSURE

2400 Primary Volts

120/240 Secondary Volts

60 Hz

kVA	Catalog Number	Case Style (Pages 254-257)	Approx. Dimensions (Inches)			Approx. Weight (Lbs.)	Mtg Type W - Wall F - Floor	Wiring Diagram (Pages 258-269)
			Width	Depth	Height			
15	F015RE	H6	21.25	20.00	28.00	200	F or W*	SCD 6
25	F025RE	H6	21.25	20.00	28.00	280	F or W*	SCD 6
37.5	F037RE	H6	21.25	20.00	28.00	300	F or W*	SCD 6
50	F050RE	H7	24.00	26.00	30.00	420	F or W*	SCD 6
75	F075RE	H7	24.00	26.00	30.00	500	F	SCD 6
100	F100RE	H8	27.00	26.00	36.00	570	F	SCD 6
150	F150RE	UH9	30.00	35.00	50.00	800	F	SCD 6
167	F167RE	J4	32.25	35.00	50.00	1000	F	SCD 6
250	F250RE	J4	32.25	35.00	50.00	1300	F	SCD 6
333	F333RE	J2	48.75	41.00	59.00	1750	F	SCD 6

*OPTIONAL WALL MOUNTING KIT REQUIRED.

4160 Primary Volts

120/240 Secondary Volts

60 Hz

kVA	Catalog Number	Case Style (Pages 254-257)	Approx. Dimensions (Inches)			Approx. Weight (Lbs.)	Mtg Type W - Wall F - Floor	Wiring Diagram (Pages 258-269)
			Width	Depth	Height			
15	F015SE	H6	21.25	20.00	28.00	200	F or W*	SCD 6
25	F025SE	H6	21.25	20.00	28.00	280	F or W*	SCD 6
37.5	F037SE	H6	21.25	20.00	28.00	300	F or W*	SCD 6
50	F050SE	H7	24.00	26.00	30.00	420	F or W*	SCD 6
75	F075SE	H7	24.00	26.00	30.00	500	F	SCD 6
100	F100SE	H8	27.00	26.00	36.00	570	F	SCD 6
150	F150SE	UH9	30.00	35.00	50.00	800	F	SCD 6
167	F167SE	J4	32.25	35.00	50.00	1000	F	SCD 6
250	F250SE	J4	32.25	35.00	50.00	1300	F	SCD 6
333	F333SE	J2	48.75	41.00	59.00	1750	F	SCD 6

*OPTIONAL WALL MOUNTING KIT REQUIRED.



COPPER WOUND, SINGLE PHASE, NEMA 1 STYLE ENCLOSURE

2400 Primary Volts

120/240 Secondary Volts

60 Hz

kVA	Catalog Number	Case Style <small>(Pages 254-257)</small>	Approx. Dimensions (Inches)			Approx. Weight (Lbs.)	Mtg Type W - Wall F - Floor	Wiring Diagram <small>(Pages 258-269)</small>
			Width	Depth	Height			
15	F015REC	H6	21.25	20.00	28.00	170	F or W*	SCD 6
25	F025REC	H6	21.25	20.00	28.00	280	F or W*	SCD 6
37.5	F037REC	H6	21.25	20.00	28.00	330	F or W*	SCD 6
50	F050REC	H6	24.00	26.00	30.00	375	F or W*	SCD 6
75	F075REC	H7	24.00	26.00	30.00	550	F	SCD 6
100	F100REC	H7	24.00	26.00	30.00	700	F	SCD 6
150	F150REC	UH9	30.00	35.00	50.00	950	F	SCD 6
167	F167REC	J4	32.25	35.00	50.00	1050	F	SCD 6
250	F250REC	J4	32.25	35.00	50.00	1400	F	SCD 6
333	F333REC	J2	48.75	41.00	59.00	1800	F	SCD 6

*OPTIONAL WALL MOUNTING KIT REQUIRED.

4160 Primary Volts

120/240 Secondary Volts

60 Hz

kVA	Catalog Number	Case Style <small>(Pages 254-257)</small>	Approx. Dimensions (Inches)			Approx. Weight (Lbs.)	Mtg Type W - Wall F - Floor	Wiring Diagram <small>(Pages 258-269)</small>
			Width	Depth	Height			
15	F015SEC	H6	21.25	20.00	28.00	170	F or W*	SCD 6
25	F025SEC	H6	21.25	20.00	28.00	280	F or W*	SCD 6
37.5	F037SEC	H6	21.25	20.00	28.00	330	F or W*	SCD 6
50	F050SEC	H6	21.25	20.00	28.00	375	F or W*	SCD 6
75	F075SEC	H7	24.00	26.00	30.00	550	F	SCD 6
100	F100SEC	H7	24.00	26.00	30.00	700	F	SCD 6
150	F150SEC	UH9	30.00	35.00	50.00	950	F	SCD 6
167	F167SEC	J4	32.25	35.00	50.00	1050	F	SCD 6
250	F250SEC	J4	32.25	35.00	50.00	1400	F	SCD 6
333	F333SEC	J2	48.75	41.00	59.00	1800	F	SCD 6

*OPTIONAL WALL MOUNTING KIT REQUIRED.

SECTION 14



ALUMINUM WOUND, THREE PHASE, NEMA 1 STYLE ENCLOSURE

2400 Delta Primary Volts 208Y/120 Secondary Volts 60 Hz

kVA	Catalog Number	Case Style (Pages 254-257)	Approx. Dimensions (Inches)			Approx. Weight (Lbs.)	Mtg Type W - Wall F - Floor	Wiring Diagram (Pages 258-269)
			Width	Depth	Height			
15	K015RB	H2	24.50	20.50	24.50	240	F or W*	SCD 8
30	K030RB	H2	24.50	20.50	24.50	380	F or W*	SCD 10
45	K045RB	H3	30.00	24.00	32.50	460	F or W*	SCD 10
75	K075RB	H3	30.00	24.00	32.50	620	F or W*	SCD 10
112.5	K112RB	H4	33.00	26.00	36.00	800	F	SCD 10
150	K150RB	H4	33.00	26.00	36.00	980	F	SCD 10
225	K225RB	J1	39.72	37.00	50.00	1450	F	SCD 10
300	K300RB	J1	39.72	37.00	50.00	1620	F	SCD 10
500	K500RB	J2	48.75	41.00	59.00	2400	F	SCD 10
600	K600RB	J3	51.75	46.00	66.00	2800	F	SCD 10
750	K750RB	J3	51.75	46.00	66.00	3150	F	SCD 10

*OPTIONAL WALL MOUNTING KIT REQUIRED.

2400 Delta Primary Volts 480Y/277 Secondary Volts 60 Hz

kVA	Catalog Number	Case Style (Pages 254-257)	Approx. Dimensions (Inches)			Approx. Weight (Lbs.)	Mtg Type W - Wall F - Floor	Wiring Diagram (Pages 258-269)
			Width	Depth	Height			
15	K015RK	H2	24.50	20.50	24.50	240	F or W*	SCD 8
30	K030RK	H2	24.50	20.50	24.50	380	F or W*	SCD 10
45	K045RK	H3	30.00	24.00	32.50	460	F or W*	SCD 10
75	K075RK	H3	30.00	24.00	32.50	620	F or W*	SCD 10
112.5	K112RK	H4	33.00	26.00	36.00	800	F	SCD 10
150	K150RK	H4	33.00	26.00	36.00	980	F	SCD 10
225	K225RK	J1	39.72	37.00	50.00	1450	F	SCD 10
300	K300RK	J1	39.72	37.00	50.00	1620	F	SCD 10
500	K500RK	J2	48.75	41.00	59.00	2400	F	SCD 10
600	K600RK	J3	51.75	46.00	66.00	2800	F	SCD 10
750	K750RK	J3	51.75	46.00	66.00	3150	F	SCD 10

*OPTIONAL WALL MOUNTING KIT REQUIRED.

2400 Delta Primary Volts 600Y/347 Secondary Volts 60 Hz

kVA	Catalog Number	Case Style (Pages 254-257)	Approx. Dimensions (Inches)			Approx. Weight (Lbs.)	Mtg Type W - Wall F - Floor	Wiring Diagram (Pages 258-269)
			Width	Depth	Height			
15	K015RP	H2	24.50	20.50	24.50	240	F or W*	SCD 8
30	K030RP	H2	24.50	20.50	24.50	380	F or W*	SCD 10
45	K045RP	H3	30.00	24.00	32.50	460	F or W*	SCD 10
75	K075RP	H3	30.00	24.00	32.50	620	F or W*	SCD 10
112.5	K112RP	H4	33.00	26.00	36.00	800	F	SCD 10
150	K150RP	H4	33.00	26.00	36.00	980	F	SCD 10
225	K225RP	J1	39.72	37.00	50.00	1450	F	SCD 10
300	K300RP	J1	39.72	37.00	50.00	1620	F	SCD 10
500	K500RP	J2	48.75	41.00	59.00	2400	F	SCD 10
600	K600RP	J3	51.75	46.00	66.00	2800	F	SCD 10
750	K750RP	J3	51.75	46.00	66.00	3150	F	SCD 10

*OPTIONAL WALL MOUNTING KIT REQUIRED.



ALUMINUM WOUND, THREE PHASE, NEMA 1 STYLE ENCLOSURE

4160 Delta Primary Volts 208Y/120 Secondary Volts 60 Hz

kVA	Catalog Number	Case Style <small>(Pages 254-257)</small>	Approx. Dimensions (Inches)			Approx. Weight (Lbs.)	Mtg Type W - Wall F - Floor	Wiring Diagram <small>(Pages 258-269)</small>
			Width	Depth	Height			
15	K015SB	H2	24.50	20.50	24.50	240	F or W*	SCD 8
30	K030SB	H2	24.50	20.50	24.50	380	F or W*	SCD 10
45	K045SB	H3	30.00	24.00	32.50	460	F or W*	SCD 10
75	K075SB	H3	30.00	24.00	32.50	620	F or W*	SCD 10
112.5	K112SB	H4	33.00	26.00	36.00	800	F	SCD 10
150	K150SB	H4	33.00	26.00	36.00	980	F	SCD 10
225	K225SB	J1	39.72	37.00	50.00	1450	F	SCD 10
300	K300SB	J1	39.72	37.00	50.00	1620	F	SCD 10
500	K500SB	J2	48.75	41.00	59.00	2400	F	SCD 10
600	K600SB	J3	51.75	46.00	66.00	2800	F	SCD 10
750	K750SB	J3	51.75	46.00	66.00	3150	F	SCD 10

*OPTIONAL WALL MOUNTING KIT REQUIRED.

4160 Delta Primary Volts 480Y/277 Secondary Volts 60 Hz

kVA	Catalog Number	Case Style <small>(Pages 254-257)</small>	Approx. Dimensions (Inches)			Approx. Weight (Lbs.)	Mtg Type W - Wall F - Floor	Wiring Diagram <small>(Pages 258-269)</small>
			Width	Depth	Height			
15	K015SK	H2	24.50	20.50	24.50	240	F or W*	SCD 8
30	K030SK	H2	24.50	20.50	24.50	380	F or W*	SCD 10
45	K045SK	H3	30.00	24.00	32.50	460	F or W*	SCD 10
75	K075SK	H3	30.00	24.00	32.50	620	F or W*	SCD 10
112.5	K112SK	H4	33.00	26.00	36.00	800	F	SCD 10
150	K150SK	H4	33.00	26.00	36.00	980	F	SCD 10
225	K225SK	J1	39.72	37.00	50.00	1450	F	SCD 10
300	K300SK	J1	39.72	37.00	50.00	1620	F	SCD 10
500	K500SK	J2	48.75	41.00	59.00	2400	F	SCD 10
600	K600SK	J3	51.75	46.00	66.00	2800	F	SCD 10
750	K750SK	J3	51.75	46.00	66.00	3150	F	SCD 10

*OPTIONAL WALL MOUNTING KIT REQUIRED.

4160 Delta Primary Volts 600Y/347 Secondary Volts 60 Hz

kVA	Catalog Number	Case Style <small>(Pages 254-257)</small>	Approx. Dimensions (Inches)			Approx. Weight (Lbs.)	Mtg Type W - Wall F - Floor	Wiring Diagram <small>(Pages 258-269)</small>
			Width	Depth	Height			
15	K015SP	H2	24.50	20.50	24.50	240	F or W*	SCD 8
30	K030SP	H2	24.50	20.50	24.50	380	F or W*	SCD 10
45	K045SP	H3	30.00	24.00	32.50	460	F or W*	SCD 10
75	K075SP	H3	30.00	24.00	32.50	620	F or W*	SCD 10
112.5	K112SP	H4	33.00	26.00	36.00	800	F	SCD 10
150	K150SP	H4	33.00	26.00	36.00	980	F	SCD 10
225	K225SP	J1	39.72	37.00	50.00	1450	F	SCD 10
300	K300SP	J1	39.72	37.00	50.00	1620	F	SCD 10
500	K500SP	J2	48.75	41.00	59.00	2400	F	SCD 10
600	K600SP	J3	51.75	46.00	66.00	2800	F	SCD 10
750	K750SP	J3	51.75	46.00	66.00	3150	F	SCD 10

*OPTIONAL WALL MOUNTING KIT REQUIRED.

SECTION 14



COPPER WOUND, THREE PHASE, NEMA 1 STYLE ENCLOSURE

2400 Delta Primary Volts 208Y/120 Secondary Volts 60 Hz

kVA	Catalog Number	Case Style <small>(Pages 254-257)</small>	Approx. Dimensions (Inches)			Approx. Weight (Lbs.)	Mtg Type W - Wall F - Floor	Wiring Diagram <small>(Pages 258-269)</small>
			Width	Depth	Height			
15	K015RBC	H2	24.50	20.50	24.50	260	F or W*	SCD 8
30	K030RBC	H2	24.50	20.50	24.50	410	F or W*	SCD 10
45	K045RBC	H3	30.00	24.00	32.50	500	F or W*	SCD 10
75	K075RBC	H3	30.00	24.00	32.50	700	F or W*	SCD 10
112.5	K112RBC	H4	33.00	26.00	36.00	820	F	SCD 10
150	K150RBC	H4	33.00	26.00	36.00	1000	F	SCD 10
225	K225RBC	J1	39.72	37.00	50.00	1500	F	SCD 10
300	K300RBC	J1	39.72	37.00	50.00	1800	F	SCD 10
500	K500RBC	J2	48.75	41.00	59.00	2600	F	SCD 10
600	K600RBC	J3	51.75	46.00	66.00	3150	F	SCD 10
750	K750RBC	J3	51.75	46.00	66.00	3500	F	SCD 10

*OPTIONAL WALL MOUNTING KIT REQUIRED.

2400 Delta Primary Volts 480Y/277 Secondary Volts 60 Hz

kVA	Catalog Number	Case Style <small>(Pages 254-257)</small>	Approx. Dimensions (Inches)			Approx. Weight (Lbs.)	Mtg Type W - Wall F - Floor	Wiring Diagram <small>(Pages 258-269)</small>
			Width	Depth	Height			
15	K015RKC	H2	24.50	20.50	24.50	260	F or W*	SCD 8
30	K030RKC	H2	24.50	20.50	24.50	410	F or W*	SCD 10
45	K045RKC	H3	30.00	24.00	32.50	500	F or W*	SCD 10
75	K075RKC	H3	30.00	24.00	32.50	700	F or W*	SCD 10
112.5	K112RKC	H4	33.00	26.00	36.00	820	F	SCD 10
150	K150RKC	H4	33.00	26.00	36.00	1000	F	SCD 10
225	K225RKC	J1	39.72	37.00	50.00	1500	F	SCD 10
300	K300RKC	J1	39.72	37.00	50.00	1800	F	SCD 10
500	K500RKC	J2	48.75	41.00	59.00	2600	F	SCD 10
600	K600RKC	J3	51.75	46.00	66.00	3150	F	SCD 10
750	K750RKC	J3	51.75	46.00	66.00	3500	F	SCD 10

*OPTIONAL WALL MOUNTING KIT REQUIRED.

2400 Delta Primary Volts 600Y/347 Secondary Volts 60 Hz

kVA	Catalog Number	Case Style <small>(Pages 254-257)</small>	Approx. Dimensions (Inches)			Approx. Weight (Lbs.)	Mtg Type W - Wall F - Floor	Wiring Diagram <small>(Pages 258-269)</small>
			Width	Depth	Height			
15	K015RPC	H2	24.50	20.50	24.50	260	F or W*	SCD 8
30	K030RPC	H2	24.50	20.50	24.50	410	F or W*	SCD 10
45	K045RPC	H3	30.00	24.00	32.50	500	F or W*	SCD 10
75	K075RPC	H3	30.00	24.00	32.50	700	F or W*	SCD 10
112.5	K112RPC	H4	33.00	26.00	36.00	820	F	SCD 10
150	K150RPC	H4	33.00	26.00	36.00	1000	F	SCD 10
225	K225RPC	J1	39.72	37.00	50.00	1500	F	SCD 10
300	K300RPC	J1	39.72	37.00	50.00	1800	F	SCD 10
500	K500RPC	J2	48.75	41.00	59.00	2600	F	SCD 10
600	K600RPC	J3	51.75	46.00	66.00	3150	F	SCD 10
750	K750RPC	J3	51.75	46.00	66.00	3500	F	SCD 10

*OPTIONAL WALL MOUNTING KIT REQUIRED.



FOR TERMINATION DETAILS SEE PAGE 270.

FOR ACCESSORIES SEE PAGE 273.



COPPER WOUND, THREE PHASE, NEMA 1 STYLE ENCLOSURE

4160 Delta Primary Volts 208Y/120 Secondary Volts 60 Hz

kVA	Catalog Number	Case Style <small>(Pages 254-257)</small>	Approx. Dimensions (Inches)			Approx. Weight (Lbs.)	Mtg Type W - Wall F - Floor	Wiring Diagram <small>(Pages 258-269)</small>
			Width	Depth	Height			
15	K015SBC	H2	24.50	20.50	24.50	260	F or W*	SCD 8
30	K030SBC	H2	24.50	20.50	24.50	410	F or W*	SCD 10
45	K045SBC	H3	30.00	24.00	32.50	500	F or W*	SCD 10
75	K075SBC	H3	30.00	24.00	32.50	700	F or W*	SCD 10
112.5	K112SBC	H4	33.00	26.00	36.00	820	F	SCD 10
150	K150SBC	H4	33.00	26.00	36.00	1000	F	SCD 10
225	K225SBC	J1	39.72	37.00	50.00	1500	F	SCD 10
300	K300SBC	J1	39.72	37.00	50.00	1800	F	SCD 10
500	K500SBC	J2	48.75	41.00	59.00	2600	F	SCD 10
600	K600SBC	J3	51.75	46.00	66.00	3150	F	SCD 10
750	K750SBC	J3	51.75	46.00	66.00	3500	F	SCD 10

*OPTIONAL WALL MOUNTING KIT REQUIRED.

4160 Delta Primary Volts 480Y/277 Secondary Volts 60 Hz

kVA	Catalog Number	Case Style <small>(Pages 254-257)</small>	Approx. Dimensions (Inches)			Approx. Weight (Lbs.)	Mtg Type W - Wall F - Floor	Wiring Diagram <small>(Pages 258-269)</small>
			Width	Depth	Height			
15	K015SKC	H2	24.50	20.50	24.50	260	F or W*	SCD 8
30	K030SKC	H2	24.50	20.50	24.50	410	F or W*	SCD 10
45	K045SKC	H3	30.00	24.00	32.50	500	F or W*	SCD 10
75	K075SKC	H3	30.00	24.00	32.50	700	F or W*	SCD 10
112.5	K112SKC	H4	33.00	26.00	36.00	820	F	SCD 10
150	K150SKC	H4	33.00	26.00	36.00	1000	F	SCD 10
225	K225SKC	J1	39.72	37.00	50.00	1500	F	SCD 10
300	K300SKC	J1	39.72	37.00	50.00	1800	F	SCD 10
500	K500SKC	J2	48.75	41.00	59.00	2600	F	SCD 10
600	K600SKC	J3	51.75	46.00	66.00	3150	F	SCD 10
750	K750SKC	J3	51.75	46.00	66.00	3500	F	SCD 10

*OPTIONAL WALL MOUNTING KIT REQUIRED.

4160 Delta Primary Volts 600Y/347 Secondary Volts 60 Hz

kVA	Catalog Number	Case Style <small>(Pages 254-257)</small>	Approx. Dimensions (Inches)			Approx. Weight (Lbs.)	Mtg Type W - Wall F - Floor	Wiring Diagram <small>(Pages 258-269)</small>
			Width	Depth	Height			
15	K015SPC	H2	24.50	20.50	24.50	260	F or W*	SCD 8
30	K030SPC	H2	24.50	20.50	24.50	410	F or W*	SCD 10
45	K045SPC	H3	30.00	24.00	32.50	500	F or W*	SCD 10
75	K075SPC	H3	30.00	24.00	32.50	700	F or W*	SCD 10
112.5	K112SPC	H4	33.00	26.00	36.00	820	F	SCD 10
150	K150SPC	H4	33.00	26.00	36.00	1000	F	SCD 10
225	K225SPC	J1	39.72	37.00	50.00	1500	F	SCD 10
300	K300SPC	J1	39.72	37.00	50.00	1800	F	SCD 10
500	K500SPC	J2	48.75	41.00	59.00	2600	F	SCD 10
600	K600SPC	J3	51.75	46.00	66.00	3150	F	SCD 10
750	K750SPC	J3	51.75	46.00	66.00	3500	F	SCD 10

*OPTIONAL WALL MOUNTING KIT REQUIRED.

SECTION 14



GENERAL INFORMATION

DIMENSIONAL DRAWINGS

'UH' SERIES ENCLOSURES

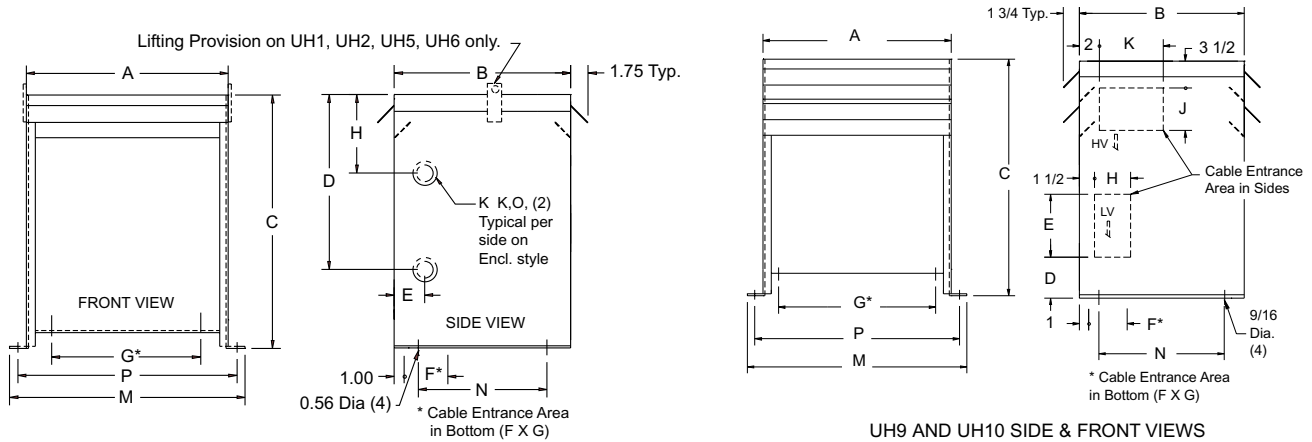

Case Style	Dimensions in Inches											
	A	B	C	D	E	F	G	H	K	M	N	P
UH1	16.75	14.00	22.00	11.00	2.50	2.25	9.00	6.00	1.38 X 1.75	19.25	9.00	18.25
UH2	21.50	19.50	29.00	15.00	2.50	3.25	14.00	6.00	1.38 X 2.50	24.00	14.50	23.00
UH3	26.00	21.00	38.00	24.00	3.00	4.75	18.00	8.00	2.00 X 3.00	28.50	16.00	27.50
UH4	30.00	24.00	39.00	24.00	3.00	3.75	20.00	9.00	2.00 X 3.00	32.50	19.00	31.50
UH5	13.00	14.00	23.00	10.00	2.50	2.25	6.00	6.00	1.38 X 1.75	15.50	9.00	14.50
UH6	16.00	19.00	31.00	15.00	2.50	2.75	7.00	6.00	2.00 X 3.00	18.50	14.00	17.50
UH7	19.50	21.00	35.00	20.00	3.00	5.25	10.00	8.00	2.00 X 3.00	22.00	16.00	21.00
UH8	24.00	25.00	39.00	24.00	3.00	4.75	11.00	9.00	2.00 X 3.00	26.50	20.00	25.50
UH9	26.50	26.00	44.00	5.00	4.00	5.00	22.50	4.50	10.00	28.50	21.50	27.50
UH10	34.00	30.00	44.00	5.00	6.00	6.00	26.50	5.00	10.00	32.50	29.00	31.50

Note: J dimension for UH9 = 3.50". J dimension for UH10 = 4.00"

'A' & 'H' SERIES ENCLOSURES

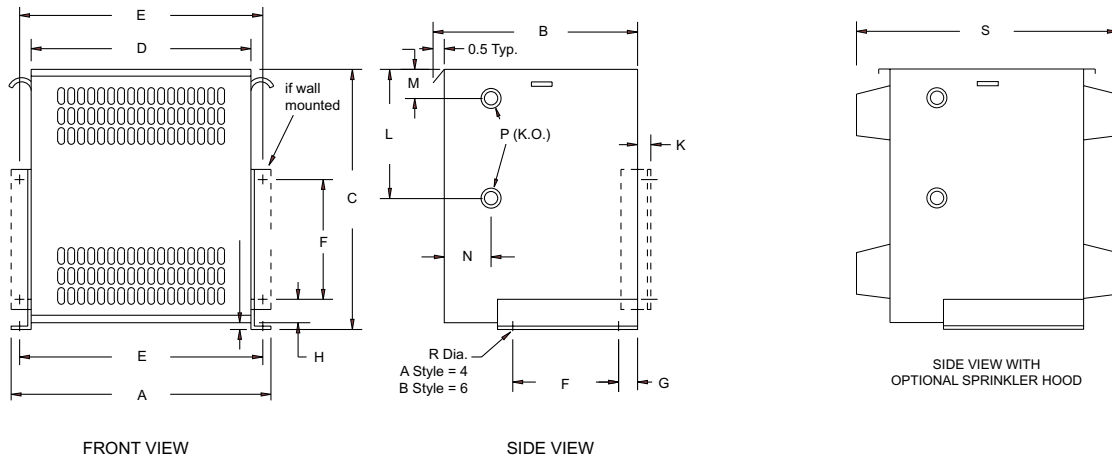

Case Style	Dimensions in Inches														
	A	B	C	D	E	F	G	H	K	L	M	N	P	R	S
A1*	12.00	7.00	10.20	10.00	11.40	5.00	0.50	0.50	0.60	5.50	1.60	1.00	0.5 X 0.75	0.31	10.00
A2*	17.25	11.25	14.00	14.75	16.50	7.00	0.90	0.90	0.40	9.50	2.00	1.00	0.75 X 1.0	0.40	13.25
H1	19.50	16.50	19.00	16.50	18.50	10.00	2.00	3.25	2.50	10.00	2.00	2.50	1.0 X 1.25	0.56	22.50
H2	24.50	20.50	24.50	21.50	23.50	10.00	2.00	3.25	2.50	12.00	2.50	2.50	1.0 X 2.0	0.56	26.50
H3	30.00	24.00	32.50	27.00	29.00	16.00	2.00	3.25	2.50	13.00	3.00	3.00	1.5 X 2.5	0.56	30.00
H4	33.00	26.00	36.00	30.00	32.00	16.00	2.00	3.25	2.50	13.00	3.00	3.00	1.5 X 2.5	0.56	32.00
H5	16.00	16.50	18.00	13.00	15.00	10.00	2.00	3.25	2.50	7.50	2.00	2.50	1.0 X 1.25	0.56	22.50
H6	21.25	20.00	28.00	18.25	20.25	10.00	2.00	3.25	2.50	12.50	3.00	2.50	1.5 X 2.5	0.56	26.00
H7	24.00	26.00	30.00	21.00	23.00	16.00	2.00	3.25	2.50	13.00	3.00	3.00	1.5 X 2.5	0.56	32.00
H8	27.00	26.00	36.00	24.00	26.00	16.00	2.00	3.25	2.50	13.00	3.00	3.00	1.5 X 2.5	0.56	32.00

* No ventilation slots in rear.

GENERAL INFORMATION

DIMENSIONAL DRAWINGS

'UJ' SERIES ENCLOSURES

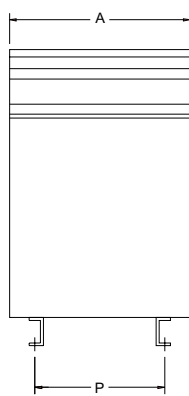

FRONT VIEW

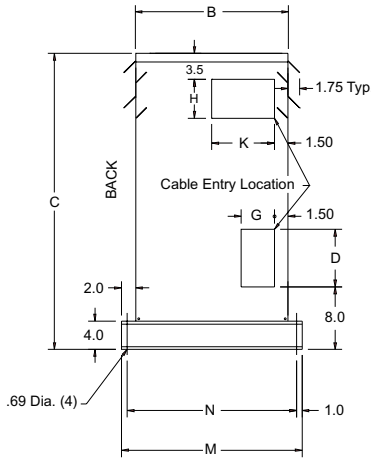

SIDE VIEW

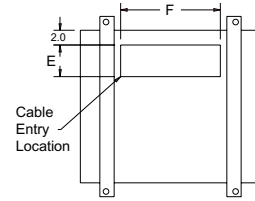

BOTTOM VIEW

Case Style	Dimensions in Inches											
	A	B	C	D	E	F	G	H	K	M	N	P
UJ1	39.50	30.00	50.00	10.00	7.50	21.50	8.00	6.50	13.50	34.00	32.00	24.00
UJ2	48.50	34.00	59.00	13.00	8.50	25.00	9.00	8.50	15.50	38.00	36.00	27.50
UJ3	51.50	39.00	66.00	16.00	9.50	31.50	10.00	11.50	18.00	43.00	41.00	34.00
UJ4	32.00	28.50	50.00	10.00	8.50	19.50	9.00	6.50	12.75	32.50	30.50	22.00
UJ5	36.00	29.50	44.00	5.00	6.50	21.50	10.00	6.50	12.75	33.00	31.00	24.00
UJ6	64.00	40.00	68.00	16.00	10.50	37.50	11.00	11.50	18.00	43.50	41.50	40.00

'J' SERIES ENCLOSURES

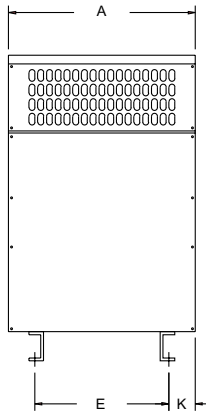

FRONT VIEW

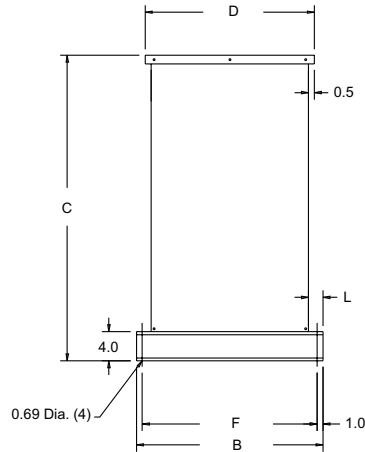

SIDE VIEW

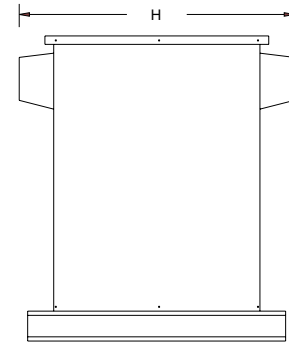

SIDE VIEW WITH
OPTIONAL SPRINKLER HOOD

Case Style	Dimensions in Inches								
	A	B	C	D	E	F	H	K	L
J1	39.72	37.00	50.00	34.25	24.00	35.00	40.00	7.75	2.00
J2	48.75	41.00	59.00	38.25	27.50	39.00	44.00	10.50	2.00
J3	51.75	46.00	66.00	43.25	34.00	44.00	49.00	8.75	2.00
J4	32.25	35.00	50.00	32.25	22.00	33.00	38.00	5.00	2.00
J5	36.00	33.00	44.00	29.50	24.00	31.00	35.50	6.00	2.25
J6	64.00	43.50	68.00	40.00	40.00	41.50	46.00	12.00	2.25

GENERAL
INFORMATION



GENERAL INFORMATION

ELECTRICAL SCHEMATICS AND CONNECTION DIAGRAMS

SCD 1

SCHEMATIC	CONNECTIONS				
	Primary Volts		Connect lines to	Inter-connect	
	480	416	H1, H4	H2-H3	
	240	208	H1, H4	H1-H3, H2-H4	
	Secondary Volts		Connect lines to	Inter-connect	
	240		X1, X4	X2-X3	
	120/240		X1, X2, X4	X2-X3	
120		X1, X4	X2-X4, X1-X3		

SCD 2

SCHEMATIC	CONNECTIONS			
	Primary Volts		Connect lines to	Inter-connect
	480		H1, H2	1-2
	468		H1, H2	2-3
	456		H1, H2	3-4
	240		H1, H2	H1-2, H2-1
	228		H1, H2	H1-4, H2-3
Secondary Volts		Connect lines to	Inter-connect	
240		X1, X4	X2-X3	
120/240		X1, X2, X4	X2-X3	
120		X1, X4	X2-X4, X1-X3	

SCD 3

SCHEMATIC	CONNECTIONS			
	Primary Volts		Connect lines to	Inter-connect
	504		H1, H4	1-H2, 2-H3, H2-H3
	492		H1, H4	2-H3, 3-H2, H2-H3
	480		H1, H4	3-H2, 4-H3, H2-H3
	468		H1, H4	4-H3, 5-H2, H2-H3
	456		H1, H4	5-H2, 6-H3, H2-H3
	252		H1, H4	1-H2, 2-H3, H1-H3, H2-H4
	240		H1, H4	3-H2, 4-H3, H1-H3, H2-H4
	228		H1, H4	5-H2, 6-H3, H1-H3, H2-H4
	Secondary Volts		Connect lines to	Inter-connect
240		X1, X4	X2-X3	
120/240		X1, X2, X4	X2-X3	
120		X1, X4	X2-X4, X1-X3	

SCD 4

SCHEMATIC	CONNECTIONS				
	Primary Volts		Connect lines to	Inter-connect	
	208	277 347 380 416 600	H1, H2	---	
	Secondary Volts		Connect lines to	Inter-connect	
	240		X1, X4	X2-X3	
120/240		X1, X2, X4	X2-X3		
120		X1, X4	X2-X4, X1-X3		

GENERAL INFORMATION

GENERAL INFORMATION

ELECTRICAL SCHEMATICS AND CONNECTION DIAGRAMS

SCD 5

SCHEMATIC		CONNECTIONS		
	Primary Volts		Connect lines to	Inter-connect
	208 240 277 416 480 600	H1, H2	1-2	
	198 228 263 395 456 570	H1, H2	2-3	
	187 216 249 374 432 540	H1, H2	3-4	
120 208 240	H1, H2	H1-2, H2-1		
108 187 216	H1, H2	H1-4, H2-3		
Secondary Volts		Connect lines to	Inter-connect	
240	X1, X4	X2-X3		
120/240	X1, X2, X4	X2-X3		
120	X1, X4	X2-X4, X1-X3		

SCD 6

SCHEMATIC		CONNECTIONS		
	Primary Volts		Connect lines to	Inter-connect
	218 291 437 504 630 2520 4368	H1, H2	1-2	
	213 284 426 492 615 2460 4264	H1, H2	2-3	
	208 277 416 480 600 2400 4160	H1, H2	3-4	
203 270 406 468 585 2340 4056	H1, H2	4-5		
198 263 395 456 570 2280 3952	H1, H2	5-6		
Secondary Volts		Connect lines to	Inter-connect	
240	X1, X4	X2-X3		
120/240	X1, X2, X4	X2-X3		
120	X1, X4	X2-X4, X1-X3		

SCD 7

SCHEMATIC		CONNECTIONS		
	Primary Volts		Connect lines to	Inter-connect
	218 252 437 483 504 630	H1, H2, H3	1	
	208 240 416 460 480 600	H1, H2, H3	2	
	198 228 395 437 456 570	H1, H2, H3	3	
Secondary Volts		Connect lines to		
208 230 240 380 416 460 480 600	X1, X2, X3			
120 133 139 220 240 265 277 347	X1, X0	X2, X0	X3, X0	

SCD 8

SCHEMATIC		CONNECTIONS		
	Primary Volts		Connect lines to	Inter-connect
	218 252 437 483 504 630 2520 4368	H1, H2, H3	1-2	
	208 240 416 460 480 600 2400 4160	H1, H2, H3	2-3	
	198 228 395 437 456 570 2280 3952	H1, H2, H3	3-4	
Secondary Volts		Connect lines to		
208 230 240 380 416 460 480 600	X1, X2, X3			
120 133 139 220 240 265 277 347	X1, X0	X2, X0	X3, X0	

GENERAL INFORMATION



GENERAL INFORMATION

ELECTRICAL SCHEMATICS AND CONNECTION DIAGRAMS

SCD 9

SCHEMATIC		CONNECTIONS			
		Primary Volts		Connect lines to	Inter-connect
		218 252 437 483 504 630 2520 4368	H1, H2, H3	1	
		Secondary Volts		Connect lines to	Inter-connect
		208 380 416 480 600	X1, X2, X3	-	
		120 220 240 277 347	X1, X0	-	
			X2, X0	-	
			X3, X0	-	

SCD 10

SCHEMATIC		CONNECTIONS			
		Primary Volts		Connect lines to	Inter-connect
		218 252 437 483 504 630 2520 4368	H1, H2, H3	1-2	
		Secondary Volts		Connect lines to	Inter-connect
		208 380 416 480 600	X1, X0	-	
		120 220 240 277 347	X1, X0	-	
			X2, X0	-	
			X3, X0	-	

SCD 11

SCHEMATIC		CONNECTIONS		
		Primary Volts		Inter-connect
		252 504	H1, H2, H3	1
		Secondary Volts		Inter-connect
		240 480	H1, H2, H3	2
		228 456	H1, H2, H3	3
		240	X1, X2, X3	-

SCD 12

SCHEMATIC		CONNECTIONS		
		Primary Volts		Inter-connect
		480 600	H1, H2, H3	1-2
		Secondary Volts		Inter-connect
		456 570	H1, H2, H3	2-3
		432 540	H1, H2, H3	3-4
		240	X1, X2, X3	-

GENERAL INFORMATION

TERMINATION DETAILS - For NEMA 1 Style Transformers

Includes: Autotransformers (Section 13) and Medium Voltage Transformers (Section 14).

SINGLE PHASE TERMINATION - AWG(MCM) OR PADS

kVA	VOLTAGE						
	120/240	277	416	480	600	2400	4160
0.25	Leads	Leads	Leads	Leads	Leads	-	-
0.5	Leads	Leads	Leads	Leads	Leads	-	-
0.75	Leads	Leads	Leads	Leads	Leads	-	-
1	Leads	Leads	Leads	Leads	Leads	-	-
1.5	Leads	Leads	Leads	Leads	Leads	-	-
2	Leads	Leads	Leads	Leads	Leads	-	-
3	Leads	Leads	Leads	Leads	Leads	-	-
5	Leads	Leads	Leads	Leads	Leads	-	-
7.5	#6-#14	#6-#14	#6-#14	#6-#14	#6-#14	-	-
10	#4-#14	#6-#14	#6-#14	#6-#14	#6-#14	-	-
15	#2-#14	#2-#14	#4-#14	#4-#14	#4-#14	#6-#14	#6-#14
25	#2/0-#6	#2/0-#6	#2-#14	#2-#14	#2-#14	#6-#14	#6-#14
37.5	#250-#6	#250-#6	#2/0-#6	#2/0-#6	#2-#14	#6-#14	#6-#14
50	#600-#2	#350-#6	#250-#6	#2/0-#6	#2/0-#6	#6-#14	#6-#14
75	2X#350-#4	#600-#2	#350-#6	#250-#6	#250-#6	#6-#14	#6-#14
100	Diagram 1D	Diagram 1D	#600-#2	#600-#2	#350-#6	#2-#14	#6-#14
150	Diagram 2	Diagram 1D	Diagram 1D	2X#350-#4	#600-#2	#2-#14	#2-#14
167	Diagram 2	Diagram 2	Diagram 1D	Diagram 1D	2X#350-#6	#2-#14	#2-#14
250	Diagram 2	Diagram 2	Diagram 2	Diagram 1D	Diagram 1D	#2/0-#6	#2-#14
333	Diagram 2	Diagram 2	Diagram 2	Diagram 2	Diagram 2	#250-#6	#2/0-#6

THREE PHASE TERMINATION - AWG(MCM) OR PADS

kVA	VOLTAGE								
	208	230	240	380	416	480	600	2400	4160
2	Leads	Leads	Leads	Leads	Leads	Leads	Leads	-	-
3	Leads	Leads	Leads	Leads	Leads	Leads	Leads	-	-
6	Leads	Leads	Leads	Leads	Leads	Leads	Leads	-	-
9	#6-#14	#6-#14	#6-#14	#6-#14	#6-#14	#6-#14	#6-#14	-	-
15	#4-#14	#6-#14	#6-#14	#6-#14	#6-#14	#6-#14	#6-#14	#6-#14	#6-#14
30	#2/0-#6	#2/0-#14	#2/0-#14	#2-#14	#4-#14	#4-#14	#4-#14	#6-#14	#6-#14
45	#250-#6	#250-#6	#250-#6	#2-#14	#2-#14	#2-#14	#4-#14	#6-#14	#6-#14
75	#600-#2	#350-#4	#350-#4	#250-#6	#2/0-#6	#2/0-#6	#2/0-#6	#6-#14	#6-#14
112.5	2X#350-#4	#600-#2	#600-#2	#350-#4	#250-#6	#250-#6	#2/0-#6	#6-#14	#6-#14
150	Diagram 1D	Diagram 1D	Diagram 1D	#600-#2	#600-#2	#350-#4	#250-#6	#6-#14	#6-#14
225	Diagram 2	Diagram 2	Diagram 1D	Diagram 1D	2X#350-#4	#600-#2	#600-#2	#2-#14	#6-#14
300	Diagram 2	Diagram 2	Diagram 2	Diagram 1D	Diagram 1D	Diagram 1D	2X#350-#4	#2/0-#6	#2-#14
500	Diagram 2	Diagram 2	Diagram 2	Diagram 2	Diagram 2	Diagram 2	Diagram 1D	#250-#6	#2-#14
600	Diagram 2	Diagram 2	Diagram 2	Diagram 2	Diagram 2	Diagram 2	Diagram 2	#250-#6	#2/0-#6
750	Diagram 2	Diagram 2	Diagram 2	Diagram 2	Diagram 2	Diagram 2	Diagram 2	#350-#4	#2/0-#6

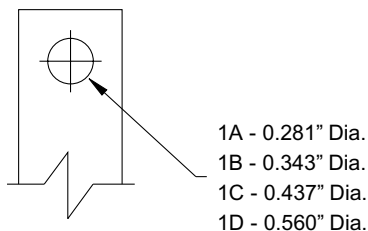

DIAGRAM 1

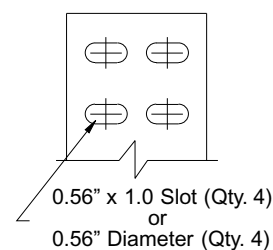

DIAGRAM 2

GENERAL INFORMATION



GENERAL INFORMATION

ACCESSORIES - GENERAL PURPOSE TRANSFORMERS

SPRINKLER HOODS

(NEMA TYPE 2 ENCLOSURE)

Sprinkler hoods can easily be field installed to protect a transformer from water falling at an angle up to 75° from vertical. A NEMA Type 1 enclosure with a properly installed sprinkler hood will meet NEMA Type 2 requirements.

Use the selection table to the right to select the appropriate sprinkler hood kit. Each kit comes with either 2 or 4 hoods, depending on the case style, to fit on transformer enclosure.

For overall dimensions of the enclosures with a sprinkler hood installed, please refer to the enclosure dimensional drawings on pages 194 thru 197.

Factory installed NEMA Type 2 enclosures are also available. Please contact the nearest Hammond Sales Office for details.

Note: UH style enclosures do not require sprinkler hood kits.

ANTI-VIBRATION PADS AND ISOLATORS

All standard transformers are supplied with installed internal vibration absorbing pads to minimize noise during operation.

Optional external “anti-vibration pads” and “vibration isolators” (for higher noise dampening) are available, and can be used to reduce operating noise even further.

Both kits are resistant to industrial contaminants like oils, acids and alkalis.

WALL MOUNTING KITS

(Used with Sprinkler Hoods)

If wall mounting is desired for a transformer fitted with sprinkler hoods, optional wall mounting brackets can be ordered separately.

Use the selection table to the right to select the appropriate kit. One kit is required for each transformer.



SPRINKLER HOOD KIT AND WALL MOUNTING BRACKET KIT PART NO.'S

Sprinkler Hood Kit Part No.	Wall Mounting Part No.	Case Style
DHA1	WB2	A1
DHA2	WB2	A2
DHH1	WB2	H1
DHH2	WB2	H2
DHH3	N/A	H3
DHH4	N/A	H4
DHH5	WB2	H5
DHH6	WB2	H6
DHH7	N/A	H7
DHH8	N/A	H8
DHJ1	N/A	J1
DHJ2	N/A	J2
DHJ3	N/A	J3
DHJ4	N/A	J4
DHJ5	N/A	J5
DHJ6	N/A	J6
N/A	W1	UH1
N/A	W2	UH2&3
N/A	W1	UH5
N/A	W2	UH6

ANTI-VIBRATION PADS

Part No.	Case Style	Description
P1	A1 - A2	Rubber and steel washer assemblies which replace the standard steel washers
	H1 - H8	
	UH1 - UH8	
P2	J1 - J6	
	UJ1-UJ6	

VIBRATION ISOLATORS

Part No.	Transformer Weight (lb)	Description
NMP1	up to 380	Moulded neoprene and steel plate assemblies to virtually eliminate vibration noise from the transformer to the mounting surface.
NMP2	381 - 760	
NMP3	761 - 1040	
NMP4	1041 - 1880	
NMP5	1881 - 2880	
NMP6	2881 - 4880	

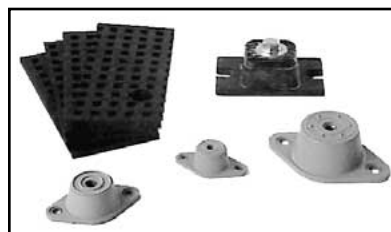

GENERAL INFORMATION

